

# Stubby Impact Socket

4525M

1/2"

- For impact wrench use
- DIN 3129, ISO 2725-2

19, 22, 24 mm

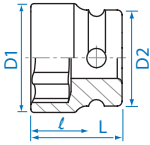

KT NO.	mm	D1 mm	D2 mm	ℓ mm	L mm	g	kg
452513M	13	20	26	5.5	28.5	57	10 / 160
452514M	14	22	26	5.5	28.5	61	10 / 160
452517M	17	26	26	5.5	28.5	64	10 / 160
452519M	19	28	26	10	28.5	63	10 / 160
452521M	21	30	30	10	28.5	81	8 / 160
452522M	22	32	30	10	28.5	87	8 / 160
452524M	24	34	30	10	28.5	80	6 / 120

# Standard Impact Socket

4535M

1/2"

- DIN 3129, ISO 2725-2

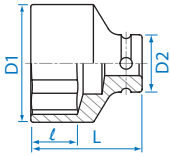

KT NO.	mm	D1 mm	D2 mm	ℓ mm	L mm	g	kg
453508M	8	15.0	25	7	38	67	10 / 200
453509M	9	16.3	25	7	38	69	10 / 200
453510M	10	17.6	25	8	38	70	10 / 200
453511M	11	18.8	25	8	38	71	10 / 200
453512M	12	20.0	25	9	38	73	10 / 200
453513M	13	21.2	25	10	38	75	10 / 200
453514M	14	22.5	25	10	38	78	10 / 200
453515M	15	23.8	30	11	38	117	10 / 160
453516M	16	25.0	30	11	38	118	10 / 160
453517M	17	26.2	30	12	38	121	10 / 160
453518M	18	27.5	30	13	38	123	10 / 160
453519M	19	28.8	30	13	38	117	10 / 160
453520M	20	29.5	30	13	38	115	10 / 160
453521M	21	30.0	30	14	40	118	8 / 160
453522M	22	31.8	30	14	40	132	8 / 160
453523M	23	33.8	30	15	40	144	8 / 160
453524M	24	33.8	30	15	42	139	6 / 120
453525M	25	35.8	30	15	42	156	6 / 120
453526M	26	37.8	30	15	42	173	6 / 120
453527M	27	37.8	30	16	44	175	6 / 120
453528M	28	39.8	30	16	44	204	6 / 120
453529M	29	39.8	30	17	44	198	6 / 120
453530M	30	41.8	30.5	17	44	206	6 / 120
453532M	32	46.0	30	19	44	239	6 / 120
453533M	33	46.0	30	19	46	246	6 / 96
453534M	34	46.0	30	20	46	240	6 / 96
453535M	35	46.0	30	20	46	227	6 / 96
453536M	36	47.0	30	20	46	243	6 / 96
453537M	37	49.0	30	21	48	271	6 / 60

KT NO.	mm	D1 mm	D2 mm	ℓ mm	L mm	g	kg
453538M	38	50.0	30	21	50	291	6 / 60
453539M	39	51.0	30	22	50	306	6 / 60
453541M	41	56.0	30	22	52	403	6 / 60
453546M	46	64.0	30	23	55	595	4 / 32

4535S

1/2"

- ANSI / ASME B107.2

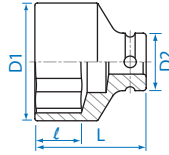

KT NO.	inch	D1 mm	D2 mm	ℓ mm	L mm	g	kg
453510S	5/16	15	25	7	38	66	10 / 200
453512S	3/8	17	25	7	38	70	10 / 200
453514S	7/16	18	25	8	38	70	10 / 200
453516S	1/2	20	25	10	38	72	10 / 200
453518S	9/16	22	25	10	38	77	10 / 200
453520S	5/8	24	25	11	38	80	10 / 160
453522S	11/16	26	30	12	38	116	10 / 160
453524S	3/4	28.8	30	13	38	116	10 / 160
453526S	13/16	30	30	14	40	127	8 / 160
453528S	7/8	32	30	14	40	136	8 / 160
453530S	15/16	34	30	15	42	152	6 / 120
453532S	1	36	30	15	42	164	6 / 120
453534S	1-1/16	38	30	16	44	180	6 / 120
453536S	1-1/8	41	30	17	44	199	6 / 120
453538S	1-3/16	42	30.5	17	44	208	6 / 120
453540S	1-1/4	46	30	18	44	237	6 / 120

# Impact Socket Set

4472MP

4472SP

1/2"

- Standard impact socket
- Stand size (mm) : 415 x 336 x 320



4472MP / 4472SP

KT NO.	PC.	Contents	Each Q'ty	
4472MP	158		8, 9, 10, 11, 12, 13, 14	8
			15, 16, 17, 18, 19, 20, 21	6
			22, 23, 24	7
			25, 26, 27, 28	6
			29, 30, 32	5
4472SP	106		5/16, 3/8, 7/16, 1/2, 9/16	8
			5/8, 11/16, 3/4, 13/16	6
			7/8, 15/16,	7
			1, 1-1/16, 1-1/8	6
			1-3/16, 1-1/4	5

KT NO.	Spec.	kg	Cuft
4472MP-A	87103	6.37	0.67
4472MP-D	158 PC. socket content	19.63	0.54
4472SP-A	87103	6.37	0.67
4472SP-D	106 PC. socket content	20.4	0.37