

## OPTIONAL ACCESSORIES:

| Code    | No.         | Designation                                |     |
|---------|-------------|--|-----|
| 2653281 | RZ-DVI20    | Reaction arm Z-form offset for DVI20       | 1,1 |
| 2653303 | RL-DVI20    | Reaction arm L-form straight for DVI20, 1" | 1,2 |
| 2653311 | RZ-DVI28    | Reaction arm Z-form offset for DVI28       | 1,5 |
| 2653338 | RL-DVI28    | Reaction arm L-form straight for DVI28, 1" | 1,7 |
| 2653346 | E-VKT-DVI20 | Spare square 1" for DVI20                  | 0,3 |
| 2670526 | E-VKR-DVI28 | Spare square 1" incl. ring for DVI28       | 0,5 |

## **i** DREMOPLUS ALU FAMILY 3

DVV-13Z



- 1** 1/2" input square
- 2** Low backlash, single-stage planetary gear for a long service life
- 3** Output square 3/4" with drill hole for impact sockets with safety pin and ring
- 4** Reaction arm: Forged reaction arm absorbs any counter force arising
- 5** Lightweight: High-performance aluminium housing is 30 % lighter than a steel one
- 6** Flexible: With detachable Z-form reaction arm; can be optionally retrofitted with long reaction arm incorporating an adjustable reaction square (L-form) of lightweight metal

## DVV-13Z

Torque Multiplier  
DREMOPLUS ALU  
1300 Nm / 950 lbf-ft

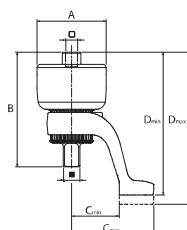

- > Controlled screw tightening and loosening
- > With single-stage planetary gear
- > High-performance aluminium housing
- > Better than +/- 3 % accuracy



- > To operate with a suitable torque wrench
- > Optionally retrofittable with straight reaction arm L-shaped
- > Model with transmission ratio 1:5
- > Also available as a set (No. DVV-13ZG) with three power wrench inserts SW 27, 30, 32 mm

| Code    | No.      | max. Nm output | max. lbf-ft output | Reaction arm    | •:• | " C  | " D  | A  | B   | C min | C max | D min | D max | max. Nm input | max. lbf-ft input |     |
|---------|----------|----------------|--------------------|-----------------|-----|------|------|----|-----|-------|-------|-------|-------|---------------|-------------------|-----|
| 2653370 | DVV-13Z  | 1300           | 950                | Z-Form, cranked | 1:5 | 1/2" | 3/4" | 80 | 133 | 56    | 95    | 165   | 173   | 270           | 200               | 1,3 |
| 2653389 | DVV-13ZG | 1300           | 950                | Z-Form, cranked | 1:5 | 1/2" | 3/4" | 80 | 133 | 56    | 95    | 165   | 173   | 270           | 200               | 3,0 |

## OPTIONAL ACCESSORIES:

| Code    | No.       | Designation                                   | C min | C max |       |
|---------|-----------|---|-------|-------|-------|
| 2653397 | RZ-DVV13  | Reaction arm Z-form offset for DVV-13         | 55    | 95    | 0,582 |
| 2653400 | RL-DVV13  | Reaction arm L-form straight for DVV-13, 3/4" | 60    | 159   | 0,800 |
| 2684233 | E-S-DVV13 | Sun gear for Torque Multiplier DVV-13         |       |       | 0,096 |