

**SI-2300**

Disc Sander

- Vertical grip for stable and easy operation sander with 7" disc



Pad/Disc Size mm/(in.)	180/(7")
Spindle Size	5/8-11UNC
Free Speed r.p.m.	4,000
Out Put Watt	409
Weight kg/(lb)	2.27/(5.01)
Noise Level dBA/(power)	82/(93)
Vibration a/k m/s <sup>2</sup>	1.4/0.6
Max Air Consumption CFM/(L/S)	23.4/(11.0)
Avg Air Consumption CFM/(L/S)	3.9/(1.8)

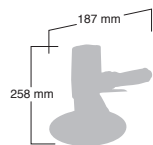

SINGLE ACTION

Standard Accessory

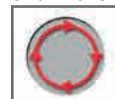

**SI-3200A**

Oscillation Sander

- Self suck system protects operator from harmful powder of paint and filler
- Oscillating mechanism tool with a triangular pad. For delicate and fine sanding work
- Special designed oscillation sander for narrow place and corner



Pad/Disc Size mm/(in.)	△75x70
Spindle Size	M8x1.25
Oscillating Angle	2.8°
Free Speed o.p.m. ★	21,000
Out Put Watt	173
Weight kg/(lb)	0.65/(1.43)
Noise Level dBA/(power)	83/(94)
Vibration a/k m/s <sup>2</sup>	9.6/2.2
Max Air Consumption CFM/(L/S)	14.4/(6.8)
Avg Air Consumption CFM/(L/S)	2.4/(1.1)

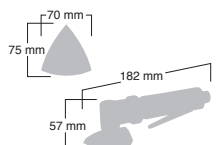

OSCILLATION

Standard Accessory



**SI-2322WR-LE**

Wet Sanding Polisher lever switch

- Wet sander designed for stone sanding and polishing with water
- Supplied with 14mm thread spindle
- Waterproofed mechanism ensures a long working life
- Suitable for diamond polishing and dry marble polishing
- Water exits through spindle



**SI-2322WR**

Wet Sanding Polisher Non lever Type

Pad/Disc Size mm/(in.)	φ80
Spindle Size	M14
Free Speed r.p.m.	5,500
Out Put Watt	435
Weight kg/(lb)	1.32/(2.91)
Noise Level dBA/(power)	88/(99)
Vibration a/k m/s <sup>2</sup>	1.7/0.6
Max Air Consumption CFM/(L/S)	24.0/(11.3)
Avg Air Consumption CFM/(L/S)	4.0/(1.9)

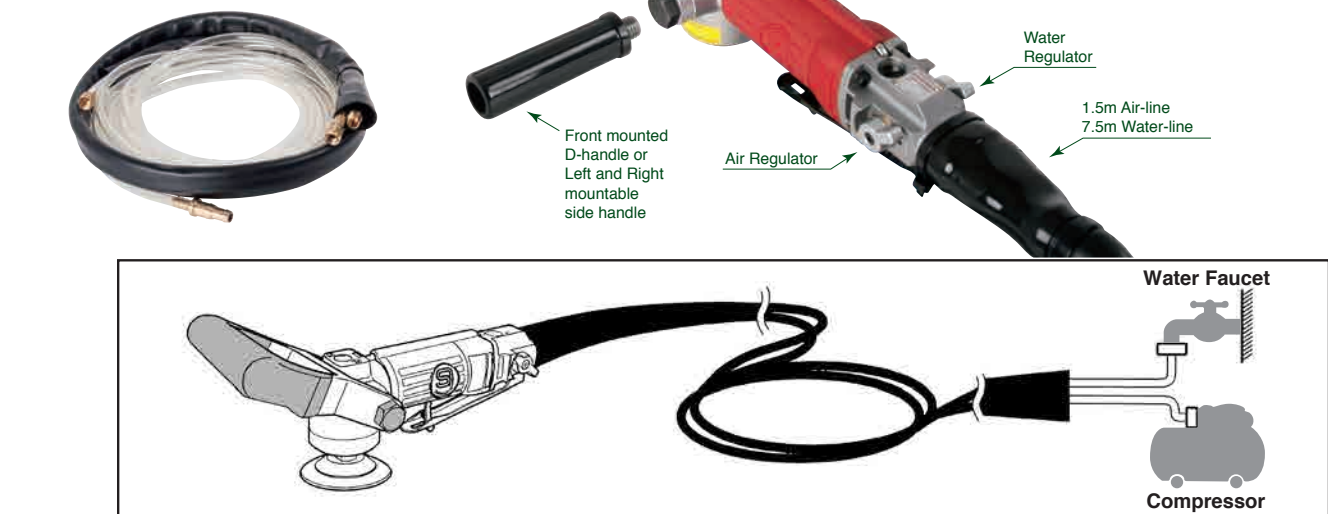
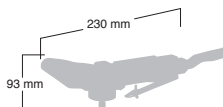

**SI-3310**

Mini Orbital Finishing Sander

- Special design for the polishing of very small scratches, marks, bubble or dust on fresh paint Surface.
- φ30mm diameter head can help you see the exact point to sand It can reduce buffing area.

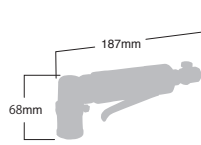

ORBITAL



Standard Accessory



Standard Accessory



Standard Accessory

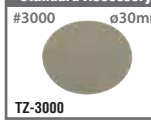

Standard Accessory



Pad/Disc Size mm/(in.)	φ30
Orbit Dia mm	3
Free Speed r.p.m.	10,000
Out Put Watt	127
Weight kg/(lb)	0.56/(1.23)
Noise Level dBA/(power)	83/(94)
Vibration a/k m/s <sup>2</sup>	10.2/2.1
Max Air Consumption CFM/(L/S)	7.2/(3.4)
Avg Air Consumption CFM/(L/S)	1.2/(0.6)



SANDERS ACCESSORIES	MESP-65	262-21MS	SHP-50M-60	TZ-3000	114DA-12	M-20x60B	M-60	119-101	119-102	170C-27	170C-30	820-52	129-100	118-3	115MB-6S	115MB-6H	1110A-80E
	φ65mm Sanding Disc	φ50mm Velcro Pad M6	φ30mm Sanding Paper	φ30mm Sanding Paper	φ75mm Velcro Pad M6	φ60mm Sponge Buff	φ60mm Wool Buff	φ80mm Sponge Buff	φ80mm Wool Buff	3" Disc Pad	4" Disc Pad	7" Back Disc	2" Disc Pad	Triangle Sanding Pad	φ30mm Soft Pad	φ30mm Hard Pad	φ80mm Velcro Pad (M14 P=Z)
SI-2008EX	☆	★	☆			☆	☆										
SI-2107A		★	★			★	★										
SI-2108EX					★			★	★								
SI-2108EX-2		★	★			★	★										
SI-2210										★	☆						
SI-2201														☆			
SI-2201-2														★			
SI-2202														☆			
SI-2202-2														★			
SI-2110S					★												
SI-2300												★					
SI-3200A														★			
SI-2322WR-LE																	☆
SI-2322WR																	☆
SI-3310				★											★	★	

★ : Standard ☆ : Option