



Pneumatic Tools

Impact wrenches



9012 Impact wrench

• **Loosening torque: 850 Nm**



- Exhaust air is guided through the handle downwards
- Reduced vibrations
- Easy handling
- Powerful pin clutch mechanism
- Air connection inlet: inside thread 12.91 mm (1/4")
- Coupler plug: Nominal size 7.2 (included)
- Recommended torque: 550 Nm
- Hose diameter (recommended): 10 mm
- Working pressure (bar): 6.3
- Sound power level: 103.1 db(A) Lp W
- Vibration acceleration: 7.42 m/s²
- Loosening torque (max) determined with screw size M: 16
- Forward and reverse: three-stage (forward), single-stage (reverse)
- Cold insulated handle
- Enhanced power characteristics due to new, specially developed air motor as well as efficient air guide and improved pull-up torque of the air motor
- Specially heat-treated inner parts for minimised wear

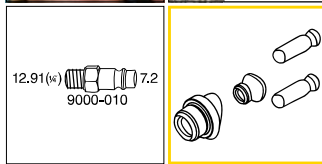
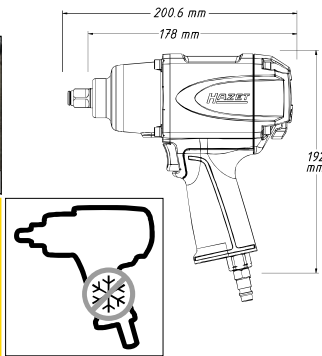

HAZET No.	max. Nm	max. Nm	l/min.	rpm	db (A) LpA	g	EAN-No. 4000896+
9012 SPC	850	750	127.4	7000	92.1	2600	119639
Silicone protective cover for 9012 SPC · 9012-1 SPC · 9012 P-1							
9012 SPC-S	-	-	-	-	-	-	222476

9012 EL-SPC Impact wrench

• **Loosening torque: 1700 Nm**



- Exhaust air is guided through the handle downwards
- Reduced vibrations
- Easy handling
- Powerful twin hammer mechanism
- Air connection inlet: inside thread 12.91 mm (1/4")
- Coupler plug: Nominal size 7.2 (included)
- Recommended torque: 881 Nm
- Hose diameter (recommended): 10 mm
- Working pressure (bar): 6.3
- Sound power level: 109 db(A) Lp W
- Vibration acceleration: 10.23 m/s²
- Loosening torque (max) determined with screw size M: 16
- Forward and reverse: four-stage (counterclockwise rotation), single-stage (clockwise rotation)
- Cold insulated handle
- **One-hand operation by changeover on rear of device**

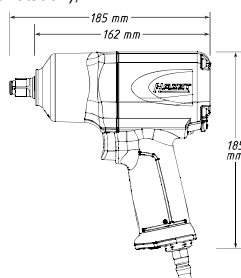

9012 EL-SPC Impact wrench

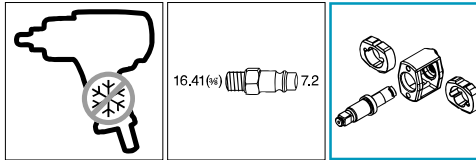

HAZET No.	max. Nm	max. Nm	l/min.	rpm	db (A) LpA	g	EAN-No. 4000896+
9012 EL-SPC	1700	1054	139	8000	98	1980	188444
Silicone protective cover for 9012 EL-SPC							
9012 EL-SPC-S	-	-	-	-	-	-	222520

9012 TT Twin Turbo impact wrench

• **Loosening torque: 2200 Nm**



- Exhaust air is guided through the handle downwards
- Reduced vibrations
- Easy handling
- Short design – only 128 mm
- HAZET Twin Turbo technology – high torques with compact design
- 8-blade air motor with 25% higher impact performance ensures maximum torque
- One-hand operation for right- and left-handed users
- Powerful twin hammer mechanism
- Air connection inlet: inside thread 12.91 mm (1/4")
- Coupler plug: Nominal size 7.2 (included)
- Recommended torque: 948 Nm
- Hose diameter (recommended): 10 mm
- Working pressure (bar): 6.3
- Sound power level: 110.7 db(A) Lp W
- Vibration acceleration: 8.69 m/s²
- Loosening torque (max) determined with screw size M: 16
- Forward and reverse: two-stage (forward), single-stage (reverse)
- Cold insulated handle



YouTube Clip

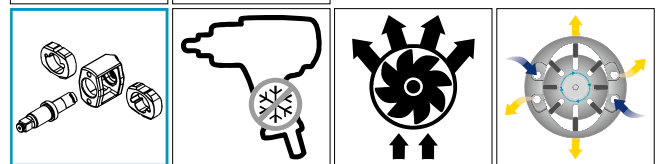
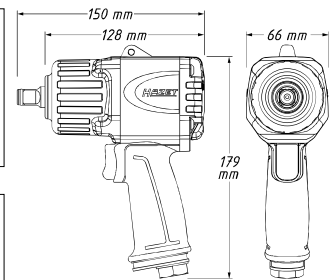

HAZET No.	max. Nm	max. Nm	l/min.	rpm	db (A) LpA	g	EAN-No. 4000896+
9012 TT	2200	1356	147.2	8300	99.7	1600	226924
Low noise hose for noise reduction of the HAZET Twin Turbo impact wrenches 9012 MTT · 9012 TT Spring clamp for fixing the hose to the handle 9040-012							
9040-012	-	-	-	-	-	-	232987