

• Spigot End

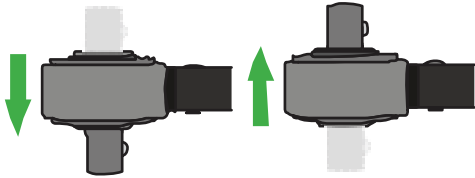

• Ratchet



- Lubrication points
- Points de graissage
- Schmierstellen
- Punti di lubrificazione
- Puntos de lubricación

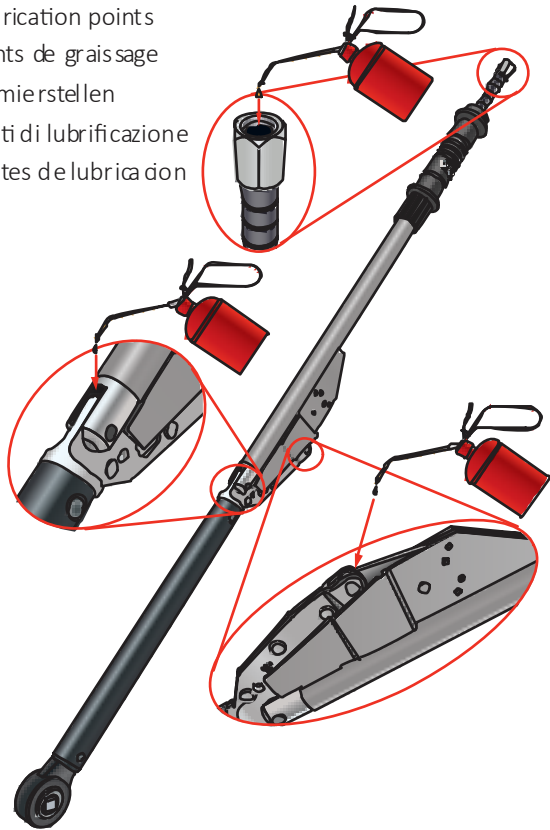

NORBAR TORQUE TOOLS LTD

Wildmere Road, Banbury,  
Oxfordshire, OX16 3JU

UNITED KINGDOM

Tel + 44 (0)1295 270333

Email enquiry@norbar.com

To find your local Norbar  
company or distributor, please  
scan the QR code below.



View our Video at:

[www.norbar.com/Products/Norbar-Videos/  
Torque-Wrench-Videos](http://www.norbar.com/Products/Norbar-Videos/Torque-Wrench-Videos)



Industrial Torque Wrench

New Generation

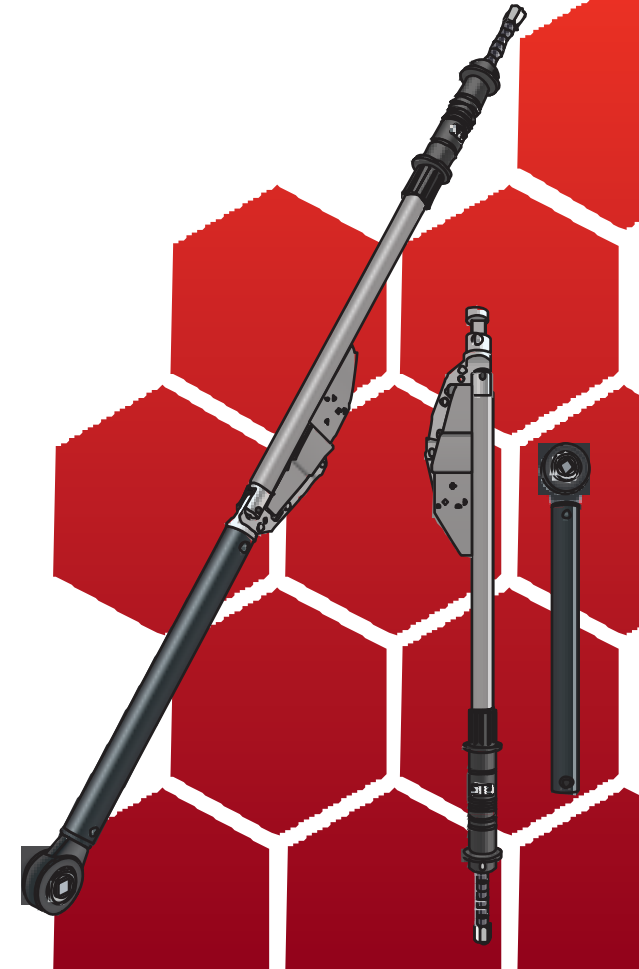

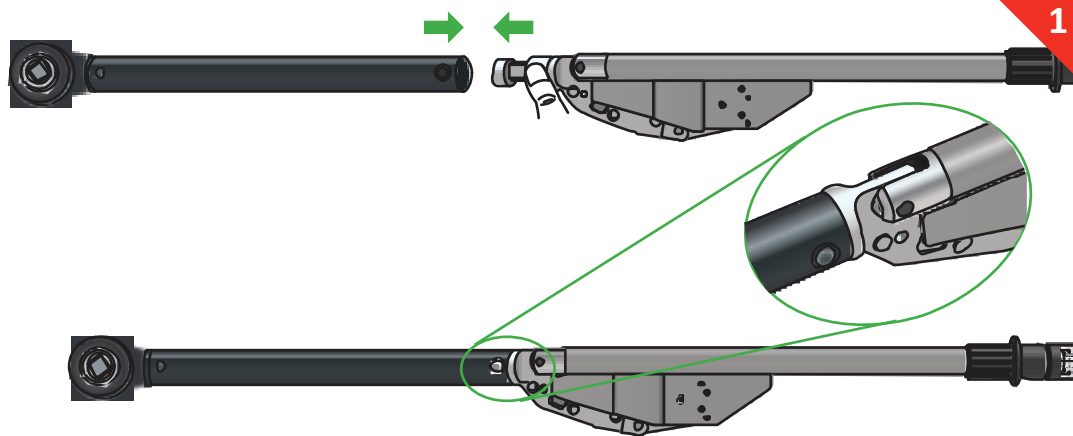

1

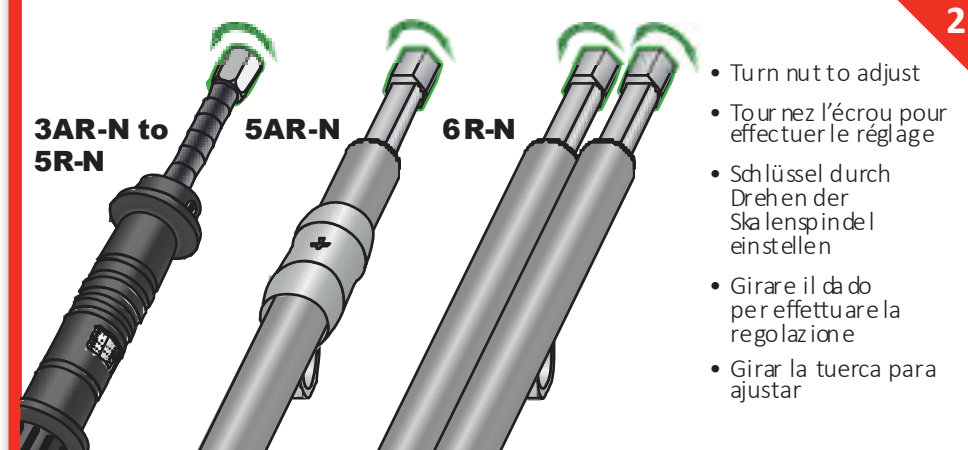

2

- Turn nut to adjust
- Tour nez l'écrou pour effectuer le réglage
- Schlüssel durch Drehen der Skalen spindle einstellen
- Girare il dado per effettuare la regolazione
- Girar la tuerca para ajustar

- Never adjust beyond the marked scale
- Ne jamais régler en-dehors de la zone de l'échelle
- Niemals über den markierten Skalenbereich hinaus einstellen
- Mai regolare la diavole oltre il marchio sulla scala
- No ajustar por debajo de la zona marcada en la escala

3

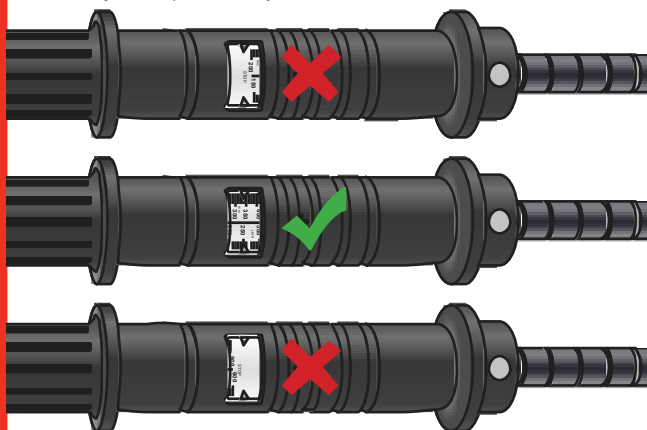

6R-N

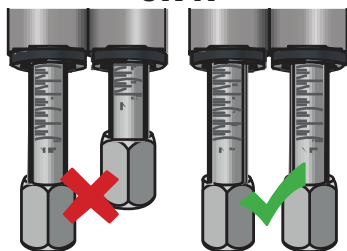

- Pull smoothly on the handle in direction indicated by arrow on body tube
- Tirer doucement sur la poignée dans le sens de la flèche sur le tube.
- Drücken Sie langsam auf den Handgriff in die Richtung, welche durch den Pfeil auf dem Rohr angezeigt wird.
- Tirare lentamente sulla manopola nella direzione indicata dalla freccia sul corpo del tubo.
- Tire suavemente del mango en la dirección de la flecha que esta marcada en el tubo

4

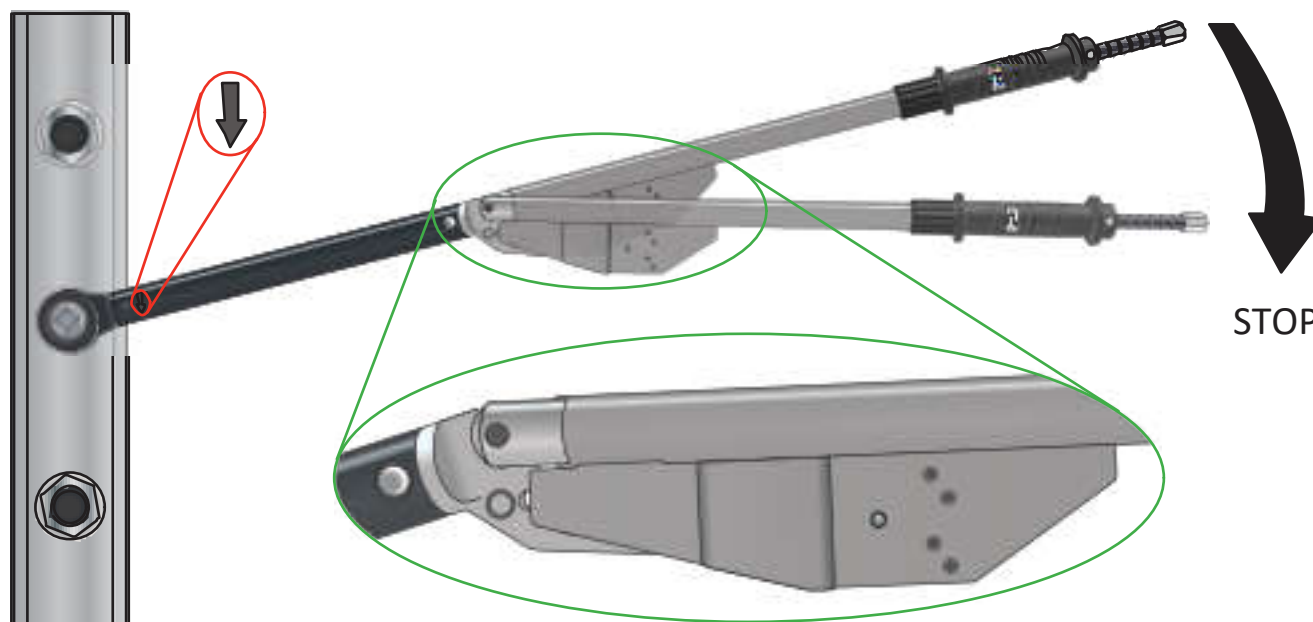

STOP